

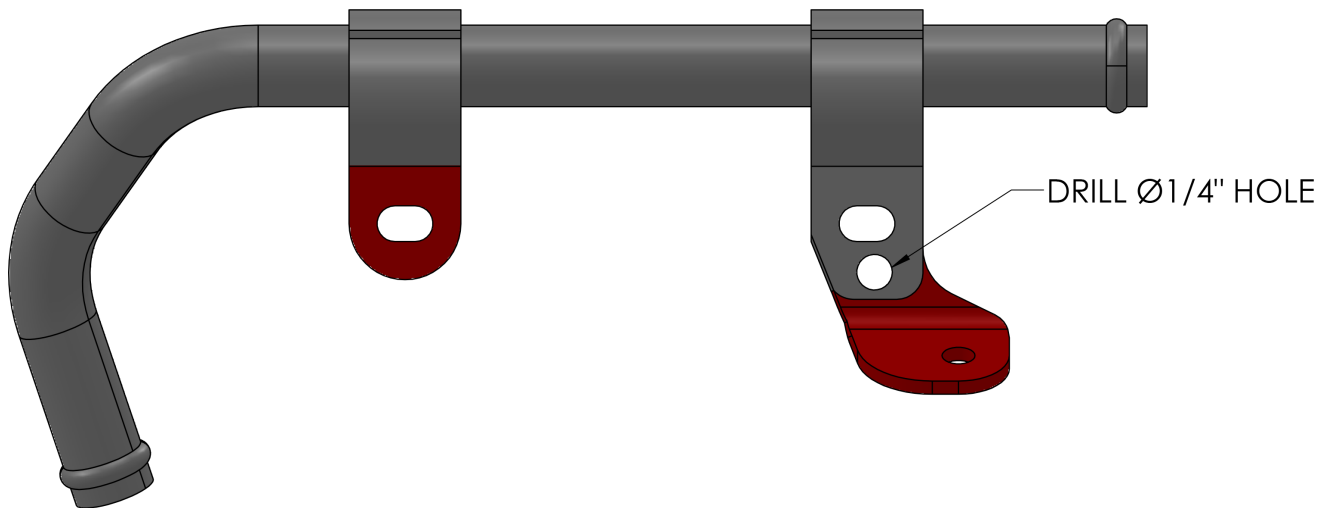

R2.8 INTAKE CLOCKING RING KIT

IMPORTANT: Thank you for purchasing a product from Axis Industries USA. We ask that you read through this entire document before proceeding with the installation. If you are not confident in your skills, please seek help from a professional to perform the installation. Upon arrival check your packages immediately to ensure that everything listed is included, and there is no damage from shipping. If anything is missing or damaged, or if you need technical assistance with the installation, call Axis Industries at 317-739-3390.

ITEM	PART No.	DESCRIPTION	QTY
1	100082	R2.8 Intake Clocking Ring	1
2	100083	M6x1, 20MM	6
3	100221	O-Ring, Dash 149	1

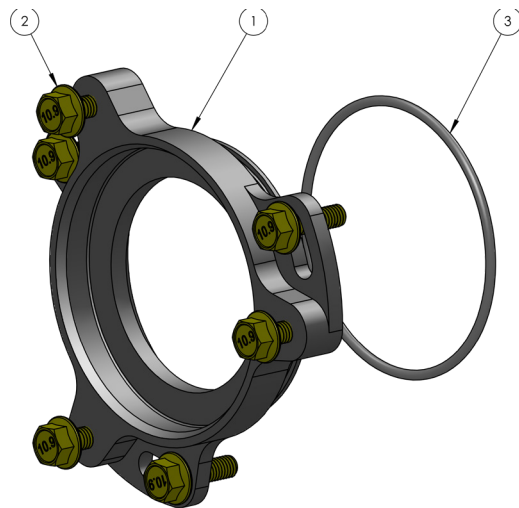
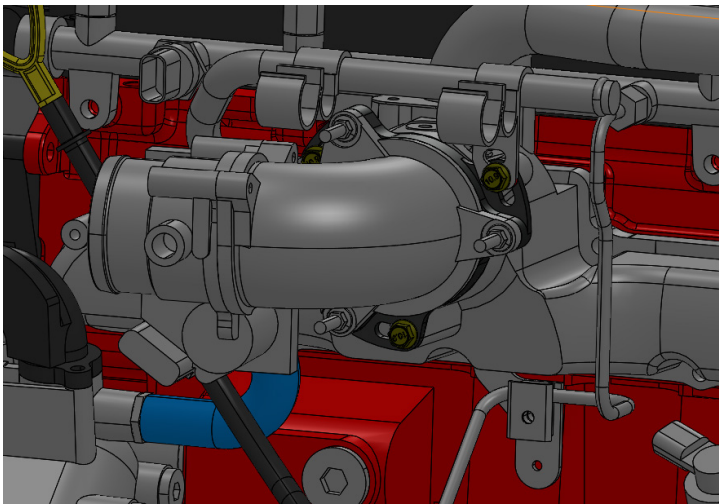

Install Steps:

- 1) Remove intake horn.
- 2) Install O-Ring(1) on to intake clocking ring.
- 3) Bolt Clocking Ring on to intake manifold to the desired position.
- 4) Trim Cummins hard Line heater hose tube as shown above
- 5) Bolt up intake horn and heater hose tube to Clocking Ring.